







-  Carrelage imitation parquet
-  Faux-Plafond et soffites (220 min)
-  Carrelage 60x60 cm
-  Terrasse en dalles sur plots
-  Terrasse en klinkers

## APPARTEMENT B21

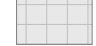
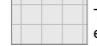
2 

1 

88,7 m<sup>2</sup> 

7,1 m<sup>2</sup> 

### SITUATION

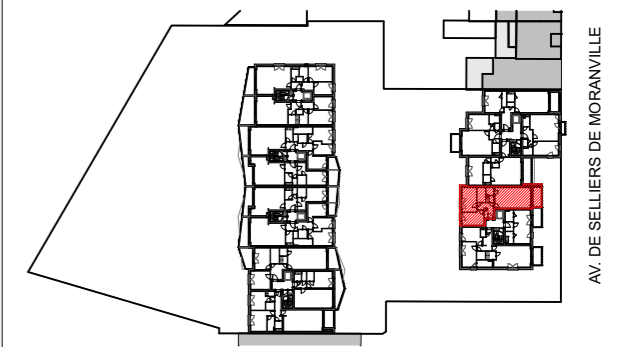

0 1 2 3 4 1/75



**Agatha**  
GARDEN

ARCHITECTES  
**ALTA**  
Atelier d'Architecture

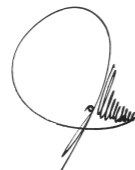

RÉALISATION

**e-maprod**

PROJET

**AVENUE DE SELLERS DE MORANVILLE**

Avenue de Selliers de Moranville, 31, 1082 Berchem-Sainte-Agathe, Belgique

PLAN DE VENTE

DATE

12/04/23

ECHELLE APPARTEMENT

1/75 B21